

T Series Tapered Caps & Plugs (cont.)

Expanded!

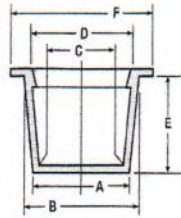

When PLUGGING
"B" Dim. must be at least 1% larger than hole to be plugged. Minimum .020".

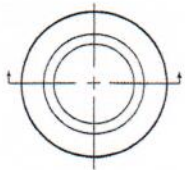

When CAPPING
"C" Dim. must be at least 1% smaller than diameter to be capped. Minimum .020".

Note:
Part numbers shown in *red italics* are also available in FlexTemp (thermoplastic rubber) Green.

Caplug No.	Dimensions												Packaging	
	A		B		C		D		E		F		Carton Quantity	Mini Pak Quantity
	In	mm	In	mm	In	mm	In	mm	In	mm	In	mm		
T-00	.116	2.95	.182	4.62	.053	1.35	.120	3.05	.38	9.65	.31	7.87	5000	1000
T-00-S	.140	3.56	.180	4.57	.088	2.24	.109	2.77	.22	5.59	.31	7.87	5000	1000
T-00-X	.145	3.68	.205	5.21	.079	2.01	.150	3.81	.38	9.65	.41	10.41	5000	1000
T-0	.173	4.39	.240	6.10	.111	2.82	.177	4.50	.38	9.65	.38	9.65	5000	1000
T-0-X	.184	4.67	.255	6.48	.113	2.87	.172	4.37	.38	9.65	.38	9.65	5000	1000
235-V	.209	5.31	.269	6.83	.150	3.81	.210	5.33	.34	8.64	.38	9.65	15000	3000
235-T	.210	5.33	.275	6.99	.146	3.71	.211	5.36	.34	8.64	.45	11.43	10000	2000
T-1	.236	5.99	.302	7.67	.174	4.42	.240	6.10	.38	9.65	.44	11.18	5000	1000
T-1-X	.267	6.78	.335	8.51	.205	5.21	.273	6.93	.38	9.65	.47	11.94	5000	1000
T-2	.299	7.59	.365	9.27	.235	5.97	.302	7.67	.38	9.65	.50	12.70	5000	1000
T-2-S	.325	8.26	.367	9.32	.263	6.68	.305	7.75	.19	4.83	.50	12.70	5000	1000
T-2-X	.330	8.38	.396	10.06	.267	6.78	.333	8.46	.38	9.65	.53	13.46	5000	1000
T-3	.361	9.17	.427	10.85	.298	7.57	.365	9.27	.38	9.65	.56	14.22	5000	1000
T-3-X	.390	9.91	.456	11.58	.327	8.31	.394	10.01	.38	9.65	.59	14.99	5000	1000
T-4	.419	10.64	.485	12.32	.356	9.04	.422	10.72	.38	9.65	.63	16.00	5000	1000
T-4-X	.447	11.35	.513	13.03	.385	9.78	.451	11.46	.38	9.65	.66	16.76	5000	1000
T-5	.471	11.96	.547	13.89	.409	10.39	.485	12.32	.44	11.18	.69	17.53	5000	1000
189-C	.477	12.12	.547	13.89	.415	10.54	.485	12.32	.31	7.87	.69	17.53	7500	1500
T-5-X	.500	12.70	.576	14.63	.440	11.18	.516	13.11	.44	11.18	.72	18.29	5000	1000
T-5-S	.533	13.54	.562	14.28	.477	12.12	.506	12.85	.22	5.59	.68	17.27	5000	1000
T-6	.532	13.51	.608	15.44	.468	11.89	.545	13.84	.44	11.18	.75	19.05	5000	1000
T-6-X	.550	13.97	.631	16.03	.487	12.37	.568	14.43	.47	11.94	.75	19.05	5000	1000
T-6-S	.554	14.07	.612	15.55	.490	12.45	.551	14.00	.31	7.87	.75	19.05	5000	1000
T-7	.580	14.73	.667	16.94	.518	13.16	.605	15.37	.50	12.70	.81	20.57	5000	1000
T-7-X	.610	15.49	.695	17.65	.549	13.95	.634	16.10	.50	12.70	.84	21.34	5000	1000
T-8	.640	16.26	.727	18.47	.578	14.68	.664	16.87	.50	12.70	.88	22.35	5000	1000
T-8-S	.669	16.99	.694	17.63	.613	15.57	.638	16.21	.19	4.83	.75	19.05	5000	1000
T-8-X	.675	17.15	.755	19.18	.613	15.57	.693	17.60	.50	12.70	.88	22.35	5000	1000
T-9	.690	17.53	.788	20.02	.628	15.95	.726	18.44	.56	14.22	.94	23.88	5000	1000
T-9-X	.725	18.42	.823	20.91	.663	16.84	.761	19.33	.56	14.22	.97	24.64	5000	1000
T-9-S	.740	18.80	.765	19.43	.678	17.22	.703	17.86	.19	4.83	.88	22.35	5000	1000
710	.750	19.05	.805	20.45	.688	17.48	.743	18.87	.19	4.83	.86	21.84	7500	1500
T-10	.750	19.05	.848	21.54	.687	17.45	.785	19.94	.56	14.22	1.00	25.40	5000	1000
T-10S	.748	19.00	.848	21.54	.687	17.45	.775	19.69	.39	9.91	1.02	25.91	5000	1000
T-11	.802	20.37	.911	23.14	.740	18.80	.849	21.57	.63	16.00	1.06	26.93	5000	1000
T-11-X	.815	20.70	.930	23.62	.753	19.13	.868	22.05	.63	16.00	1.09	27.69	5000	1000
T-15-A	.836	21.24	1.305	33.15	.777	19.74	1.247	31.68	1.06	26.93	1.43	36.32	2500	500
T-11-S	.837	21.26	.890	22.61	.757	19.23	.810	20.57	.22	5.59	1.05	26.67	5000	1000
192-2-C	.854	21.69	.958	24.33	.790	20.07	.894	22.71	.66	16.76	1.13	28.70	2500	500
T-12	.866	22.00	.975	24.77	.803	20.40	.912	23.17	.63	16.00	1.13	28.70	5000	1000
192-1	.869	22.07	.973	24.71	.805	20.45	.909	23.09	.75	19.05	1.13	28.70	2500	500
T-12-X	.915	23.24	1.040	26.42	.855	21.72	.980	24.89	.69	17.53	1.16	29.47	5000	1000
249-2	.950	24.13	1.090	27.69	.890	22.61	1.030	26.16	1.03	26.16	1.25	31.75	1500	300
277	.955	24.26	1.040	26.42	.895	22.73	.980	24.89	.50	12.70	1.16	29.46	3500	700
T-13-A	.960	24.38	1.047	26.59	.900	22.86	.987	25.07	.50	12.70	1.19	30.23	5000	1000
T-13	.964	24.49	1.090	27.69	.901	22.89	1.027	26.09	.75	19.05	1.25	31.75	2500	500
249-W	.975	24.77	1.104	28.04	.918	23.32	1.047	26.59	.75	19.05	1.44	36.58	2000	400
T-13-X	.995	25.27	1.145	29.08	.933	23.70	1.083	27.51	.75	19.05	1.31	33.28	2500	500
709	1.020	25.91	1.040	26.42	.940	23.88	.960	24.38	.88	22.35	1.31	33.27	1500	300
T-14	1.094	27.79	1.215	30.86	1.031	26.19	1.152	29.26	.75	19.05	1.41	35.82	2500	500
T-16-A	1.140	28.96	1.420	36.07	1.085	27.56	1.358	34.49	.81	20.57	1.56	39.63	2500	500
T-14-X	1.175	29.85	1.284	32.61	1.113	28.27	1.222	31.04	.63	16.00	1.44	36.58	2500	500
250-SW	1.175	29.85	1.284	32.61	1.113	28.27	1.222	31.04	.66	16.76	1.67	42.42	2000	400
250	1.179	29.95	1.286	32.66	1.115	28.32	1.222	31.04	.75	19.05	1.44	36.58	1500	300
T-15	1.224	31.09	1.355	34.42	1.161	29.49	1.292	32.82	.75	19.05	1.50	38.10	2500	500
T-15-X	1.235	31.37	1.360	34.55	1.173	29.80	1.298	32.97	.81	20.57	1.50	38.10	2500	500
T-17-A	1.239	31.47	1.507	38.28	1.169	29.69	1.437	36.50	.75	19.05	1.63	41.40	2500	500
1153	1.276	32.41	1.312	33.32	1.155	29.32	1.190	32.23	.56	14.20	1.38	35.05	2000	400
T-15-S	1.285	32.64	1.346	34.19	1.227	31.17	1.288	32.72	.38	9.65	1.47	37.34	5000	1000
252	1.292	32.82	1.356	34.44	1.231	31.27	1.295	32.89	.75	19.05	1.50	38.10	1500	300
T-16	1.312	33.33	1.465	37.21	1.249	31.73	1.402	35.61	.88	22.35	1.63	41.40	2500	500
253	1.312	33.32	1.465	37.21	1.248	31.70	1.401	35.59	.75	19.05	1.62	41.15	1500	300
253-2	1.344	34.14	1.507	38.28	1.282	32.56	1.445	36.70	.94	23.88	1.77	44.96	1000	200
253-S	1.350	34.29	1.465	37.21	1.286	32.66	1.401	35.59	.53	13.46	1.62	41.15	2000	400
T-16-S	1.395	35.43	1.465	37.21	1.345	34.16	1.405	35.69	.39	9.91	1.59	40.39	1000	200
727	1.435	36.45	1.500	38.10	1.340	34.04	1.420	36.07	.80	20.32	1.75	44.45	1000	200
T-20-A	1.440	36.58	1.895	48.13	1.378	35.00	1.833	46.56	1.28	32.51	2.06	52.33	1000	200
T-17	1.447	36.76	1.600	40.64	1.384	35.15	1.537	39.04	.88	22.35	1.75	44.45	1000	200
254-S	1.447	36.75	1.600	40.64	1.384	35.15	1.537	39.04	.94	23.88	1.75	44.45	1000	200
254	1.451	36.86	1.601	40.67	1.387	35.23	1.537	39.04	.75	19.05	1.75	44.45	1000	200
T-17-S	1.513	38.43	1.600	40.64	1.451	36.86	1.537	39.04	.50	12.70	1.75	44.45	2500	500
194	1.519	38.58	1.602	40.69	1.455	36.96	1.538	39.07	.75	19.05	1.75	44.45	1800	360
T-18	1.560	39.63	1.682	42.72	1.498	38.05	1.620	41.15	.75	19.05	1.88	47.75	1000	200
195-S	1.574	39.98	1.688	42.88	1.514	38.46	1.628	41.35	.62	15.75	1.88	47.75	5000	1000
T-18-X	1.630	41.40	1.750	44.45	1.568	39.83	1.688	42.88	.75	19.05	1.94	49.28	1000	200